

29.7 m 2025 Marcelo Penna Vork 98 Power Catamaran

Call Tax: Not Paid

Barcelona, Spain

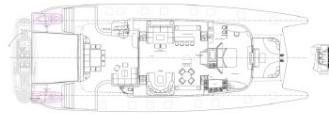
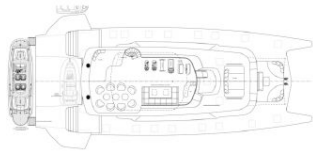
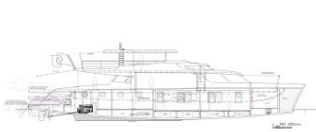

Boat Details

Make:	Marcelo Penna	Class:	Motor Yacht	Heads:	6
Model:	Vork 98 Power Catamaran	Hull Material:	Fiberglass	Fuel Type:	Diesel
Year:	2025	Drive Type:	Shaft Drive	Max Draft:	1 m 20 cm
Length:	29 m 75 cm	Beam:	11 m 60 cm		
Price:	Call	Boat Location:	Barcelona, Spain		
Condition:	New	Cabins:	5		

Description

The 29.75m MARCELO PENNA VORK 98 Power Catamaran, is the latest project developed by Marcelo Penna at MP Yacht Design. Designed and built in carbon fibre in accordance with the EU Class A, this maxi power catamaran comfortably accommodates in luxury and style up to 10 guests in 5 en-suite cabins, and 5 crew.

The vessel's layout spans two vast decks. An enormous aft high-low bathing platform fitted with foldable decks precedes the cockpit with an outdoors dining area and an L-shaped settee with a pantry. A very practical feature is the day head located right in front of the starboard staircase.

The main saloon welcomes guests with a huge lounging area, suitable for big gatherings including a Home Theatre. There is bar with stools on portside, and extendable gaming/formal table.

The panoramic Master suite is located forward of the saloon, it's versatile layout can be customised, as there is more than enough space for walk-in dressing room, office, His and Hers en-suite bathroom, and double central King-size bed facing forward.

The lower deck hosts the main engines and generators room, followed by the Captain's cabin, guests double cabins, two of them being real VIP suites with additional lounge areas. 2 double crew cabins and crew mess/laundry area are located in the starboard forepeak, while the Captain's cabin is aft of the

Please click on the « Other Details » tab for complete specifications of this Yacht for Sale.

fully fitted galley and dinette on the port hull.

The sundeck encompasses sunbathing areas, soft armchairs, dining table, gym machines, pilot station, and a BBQ/pantry counter.

Propelled by twin 730 Hp MAN diesel engines and complemented by two tunnel bow thrusters for enhanced manoeuvrability, she reaches a maximum speed of 16 knots, while comfortably cruising at 12 knots.

This last-generation catamaran is managed by a Power Management System (PMS) that ensures optimal fuel consumption and engines performance. Harnessing solar energy through solar panels installed on hard top will add up plenty of power supply necessary for hotel load.

Comfortable, spacious, safe and sturdy, this MARCELO PENNA VORK 98 Power Catamaran, is ideal for long-term stay on board and lengthy cruising, and suitable for charter or private use.

Please click on the « Other Details » tab for complete specifications of this New Construction Maxi Power Catamaran for Sale.

Delivery: 24 Months from order.

Information & Features

MAN D2676 LE443 (Engine 1)

Type:	Inboard	Power:	730 hp
Fuel Type:	Diesel		
Drive Type:	Shaft Drive		

MAN D2676 LE443 (Engine 2)

Type:	Inboard	Power:	730 hp
Fuel Type:	Diesel		
Drive Type:	Shaft Drive		

Dimensions

LOA: **29 m 75 cm** Max Draft: **1 m 20 cm**
LWL: **28 m 14 cm**
Beam: **11 m 60 cm**

Accommodations

Cabins: **5**
Heads: **6**

Other

Warranty: **5 Years** Builder: **Marcelo Penna Group (Spain)**
Hull Shape: **Catamaran**
Designer: **Marcelo Penna Yacht Design**

Full Specs

MAIN CHARACTERISTICS

Builder: Marcelo Penna Group (Spain)

Model: Marcelo Penna Vork 98 Power Catamaran

Project: MP Yachts Custom

Type: Power Catamaran / Maxi Catamaran / Multihull

Construction Material: Carbon fibre and epoxy resin / Corecell technology

Decks: Teak

Length Overall: 29.75 m (97' 7")

Waterline Length: 28.14 m (92' 4")

Beam: 11.60 m (38' 1")

Draught: 1.20 m (3' 11")

Cabin Headroom: 2.10 m (6' 11")

Displacement: 80,000 kgs (176,370 lbs)

Classification: RINA CE Class A

PROPULSION

Type / Fuel: Twin Diesel

Main Engines: 2 x 730 Hp MAN D2676 LE443

Cruising Speed: 12 knots

Maximum Speed: 16 knots

Drives: 2 x Stainless-steel water-lubricated shafts

Propellers: 2 x Fixed pitch propellers in NiBrAl

Rudders: 2 x Units free hanging spade type rudders

Steering: Hydraulic, with hydraulic rams on each rudder, two hydraulic pumps on the pilot stations, and connection boxes for all the system and the automatic pilot electrohydraulic pump

TANKAGE

Fuel Capacity: 20,000 l (5,283 USG)

Fresh Water Capacity: 3,000 l (792.5 USG)

Black/Grey Water Capacity: 2,000 l (528 USG)

Sludge/Bilge Tanks: 2 x 750 l (198 USG) each

ACCOMMODATION

(Standard proposed)

10 Guests in 5 en-suite staterooms

5 Crew in 3 cabins

Port Hull:

- Captain's cabin aft with en-suite bathroom and shower room
- Fully equipped galley and crew mess
- 2 x Guest double cabins, each with closets and en-suite bathrooms
- Family room forward with convertible double bed

- 2 x Stairwell accesses, 1 for guest area, 1 for crew/galley area

Central Platform:

- U-shaped saloon lounging area to port
- V-Shaped saloon lounging area to starboard
- Pantry/bar counter to port with stools
- Central forward inner steering station
- Starboard gaming/formal dining area with extendable table
- Forward panoramic Master suite with walk-in dressing room, lounge, desk/vanity and en-suite bathroom with double sinks

Starboard Hull:

- 2 x VIP double cabins, each with closets and en-suite bathrooms
- 2nd Crew mess forward with laundry room
- 2 x Crew cabins with bunkbeds, each with en-suite bathrooms
- 2 x Stairwell accesses, 1 for guest area, 1 for crew/laundry area

LAYOUT

Lower Deck:

- 2 x SEA BOB storages under stairs to cockpit
- Steering spaces aft
- Main engines & generators rooms aft
- Guest cabins
- Crew cabins
- Galley
- Crew dinette
- Crew mess/laundry
- Fore peaks
- Bow thruster rooms

Main Deck:

- Aft deck side platforms
- Aft deck Personal Watercraft Platforms with tender cranes
- Aft central platform with sealift system to store small tender
- Exterior stairs with access to main deck
- Aft cockpit
- Exterior day head on starboard side
- Staircase to sundeck
- Main saloon
- Mid lounge with bar counter, dining & game table & inner pilot station
- Master cabin, dressing and bathroom
- Forward cockpit & sun beds
- Fore deck with two windlasses and anchors

Sundeck:

- Sunbathing area aft
- Exterior stairs to main deck

- Soft armchairs area
 - Dining table & sofa
 - Gym machines
 - Exterior pilot station
 - BBQ & pantry counter
-
- Please contact us for alternative layout options

MAIN EQUIPMENT

Electrical Circuits:

- 380V AC to feed machineries
- 230V AC to feed domestic appliances and low power users
- 12V DC to feed tools
- 24V DC for emergency lighting

Batteries:

- Starting batteries for the main engines and generators.
- Main service batteries for hotel loads

Battery Chargers: MASTERVOLT, ENERVOLT, VICTRON

Emergency Lighting: Self-contained emergency source of electrical power (2 gel batteries of enough capacity)

Shore Power Supply: Shore power cables of 50m and converter unit

2 x 50 kW KOHLER diesel generators @1500 RPM / 50Hz / 1-Phase

Thrusters: 2 x Electrical bow thrusters, 9.6 kW each, LEWMAR 250TT

Watermakers: 2 x Reverse osmosis SEA RECOVERY, IDROMAR 150 to 250 l/h

Toilets: TECMA, JABSCO

Galley, Laundry Equipment: MIELE, ROLAND, MKN

Airconditioning: Complete system for the ventilation and air-conditioning of all compartments of the yacht
CRUISAIR, VECO, with a central unit and fan-coil units on each area

Hot Water Plant: 2 x Electrical hot water boilers 100 l

Bilge System: 2 x Power bilge pumps, installed in separate watertight compartments. Additionally, submergible pumps will be installed on each compartment

Sewage Treatment Plant: 2,500 l/day SELMAR

Transfer Pump: 2 x Pumps JABSCO

Fire Pumps: 2 x Independently driven fire pumps and portable engine operated fire pump with hydrant connections

Fire Detection & Alarm System: Managed from monitoring and control system TYCO, CONSILIUM

Bridge Demisting System: Efficient demisting arrangement installed in the wheelhouse windows

NAVIGATION / COMMUNICATION EQUIPMENT

Boat speed & log

Echo sounder

Anemometer & wind direction

GPS / Plotter / Electronic Chart System: FURUNO, SAGEM, ANTHEA, C.PLATH, CONSILIUM

Autopilot

Electronic compass

Magnetic Compass: C. PLATH, LUDOLF, CASSENS UND PLATH

VHF with AIS - GMDSS

Portables VHF - GMDSS Radar

Integrated Control System: Onboard a monitoring, control and alarm system C-ZONE with enough channels to monitor and control the services. Capable to notify alarm status to predetermined PDA, laptop or mobile device. On pilot station consoles will be ergonomically integrated LCD monitors. Other spaces where will be fitted monitors are the Captain's cabin, crew mess and Master cabin

ENTERTAINMENT EQUIPMENT

Sound System: BOSE, LINN, KVH Sat TV, iPort

Centralized distribution system for TV, radio, Wi-Fi internet to all accommodation areas and cabins

All on board entertainment sources integrated into one control system for multiple users throughout the vessel. Each user will be able to access and control music & video from CD, DVD, radio, satellite, or the central music & video library from any cabin

Interior and exterior waterproof loudspeakers

Cinema arranged on the main deck, theatre system with in-ceiling loudspeakers

Smart TV system

USB chargers & connectors

Internet: STARLINK system to supply internet services on board, as well as a Wi-Fi router

CCTV & NIGHT VISION

Exterior and interior cameras connected to a closed circuit with displays and control panels in the interior pilot station, crew rest area and Captain's cabin TELEMAR, SECURE YACHT, MARINE GUARD

2 x Marine night vision devices FLIR

DECK EQUIPMENT

Deck Hardware: LEWMAR / HARKEN

Windlasses: 2 x Hydraulic, LEWMAR V8 2500W

Anchors: 2 x Galvanised high holding power (HHP) ROCNA, 70 kg (154 lb)

Chains: 2 x Galvanized, 100m each

Mooring Capstans: 2 x Stainless-steel electric, LEWMAR

Crane: H&B TECHNICS, BESENZONI, OPACMARE

Gangway: H&B TECHNICS, BESENZONI, OPACMARE

Bathing Ladders: 2 x Retractable electro-hydraulic stainless-steel on each hull H&B TECHNICS, BESENZONI, OPACMARE

Boarding Ladders: 2 x Foldable carbon fibre boarding ladders, installed on both aft platforms or on both sides H&B TECHNICS, BESENZONI, OPACMARE

Bathing Platform: Hydraulic foldable Tenderlift system H&B TECHNICS, BESENZONI, OPACMARE

Chain Lockers: 2 x Located forward in the main deck on each hull

Searchlight: Remote-controlled searchlight

Underwater Lights: 4 x LED at transom OCEANLED

Liferafts: 2 x SOLAS approved life rafts VIKING, ZODIAC, with capacity for 15/20 persons each and hydrostatic release

Air Horn: Electric, installed on the mast

Solar Panels: Installed on hard top, for power supply necessary for hotel load SOLARA

TENDER

To be supplied by Owner, not included in the price

Yacht Brochure

Available on request.

Delivery

24 Months from firm order.

Warranty

5 Years on the hull, 2 years on the rest of the ship's systems.

Berth

Berth place management possible on French or Italian Riviera as well as Spain (Mainland and Balearic Islands), Greece and Turkey.

Winter berth with competitive rates available at the yard in Spain afloat or in dry-dock.

Disclaimer

These particulars are given in good faith as supplied to us but cannot be guaranteed and cannot be used for contracts.

