

27.5 m 2025 Custom Pajot Eco Yacht 90 Catamaran

€9,300,000 Tax: Not Paid

Ancona, Italy

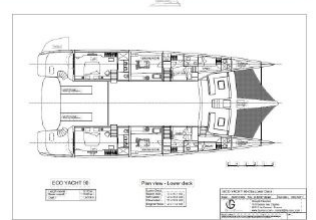
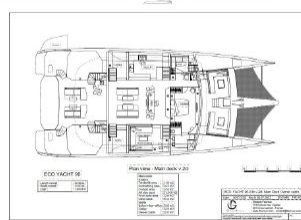
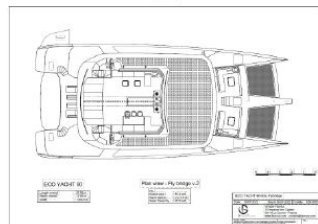

Boat Details

Make:	Custom	Class:	Catamaran	Heads:	4
Model:	Pajot Eco Yacht 90 Catamaran	Hull Material:	Aluminium	Fuel Type:	Other
Year:	2025	Drive Type:	Shaft Drive	Max Draft:	3 m 70 cm
Length:	27 m 50 cm	Beam:	12 m		
Price:	€9,300,000	Boat Location:	Ancona, Italy		
Condition:	New	Cabins:	4		

Description

The 27.50m PAJOT CUSTOM ECO YACHT 90' is the new addition to innovating line of Eco-Yacht 115' and 145' hybrid catamarans, developed by Pajot Custom Yachts and the Italian shipyard Wider. This new multihull appeared in response of the growing demand for the sustainable yachts.

The PAJOT CUSTOM ECO YACHT 90 repeats many of her bigger allies features. Exterior details include aluminium built, the cutting-edge design for hulls, efficient sail layout with boomless main sail, retractable center board, allowing shallow draft.

Hybrid power system comprises extensive use of solar panels (50m²) combined with new generation electric propulsion by in-house Wider Management System (WMS). No engine noise, no vibrations and no CO₂ emissions in "hotel" mode.

The unique design of the new PAJOT CUSTOM ECO YACHT 90' boasts a full beam saloon (75m²) with 150-degree view from the galley, home cinema area, followed by panoramic master cabin with direct access to the fore private deck with a private lounging area and jacuzzi(option). Two spacious VIP cabins of 20m² each are located on the lower deck, both equipped by private beach club terraces with direct access to water.

Marc Pajot and Marcello Maggi (Wider shipyard's CEO) are very enthusiastic about this project which marks a new milestone in catamaran construction.

"Catamaran hulls feature a low hydrodynamic drag, a simple and efficient sail system, a large source of solar and hydraulic energy associated with hybrid electric propulsion bringing technology to the service of ecology. This is the birth of a real E-yacht." – Marc PAJOT

KEY FEATURES

- **Economic and environmental-friendly hybrid operation**
 - Built in aluminium (sustainable material) for lightness and strength
 - Low drag of catamaran hulls
 - Simple and efficient sail propulsion
 - Noiseless, hybrid propulsion by electric motors
 - Service power supplied by hydrodynamic generators
 - Service power supplied by a large solar panel area of 47 m²
 - Long-range diesel-electric propulsion energy
 - Zero CO₂ emissions coastal sailing over 30 nautical miles
- **Easy sail handling and manoeuvring**
 - There are 3 separate helm stations one on each hull on each side of the salon and one inside, all comfortably appointed but set apart from the "guests"
 - The main sail is a "boom-less" cutting-edge design providing maximum wind efficiency, ease of use and safety. The hi-tech mast is all carbon fiber for strength and lightness
 - Deploying or furling the forward sails is fast and easy thanks to their electric furlers
- **Extreme spaciousness, private areas indoors and outdoors**
 - Full beam saloon of 75m² (775 sq. ft.) with 150-degree view from the galley, home cinema area
 - Customized fore deck use: one full-beam master with private deck and jacuzzi
 - Manoeuvring areas for the crew clearly separated from those of the guests
 - Two spacious and luxurious VIP cabins - each 20m² (215 sq. ft.) featuring private beach club terraces

Please click on the « Full Specs » tab for complete details of this new Construction Maxi Catamaran for Sale.

Note: This is a brand-new Yacht, under full Manufacturer's warranty.

Delivery: 18 Months from firm order.
Information & Features

Hybrid-Electric (Engine 1)

Type:	Inboard	Power:	268 hp
Fuel Type:	Other		
Drive Type:	Shaft Drive		

Hybrid-Electric (Engine 2)

Type:	Inboard	Power:	268 hp
Fuel Type:	Other		
Drive Type:	Shaft Drive		

Dimensions

LOA:	27 m 50 cm	Min Draft:	1 m 90 cm
LWL:	26 m 60 cm	Max Draft:	3 m 70 cm
Beam:	12 m		

Accommodations

Cabins:	4
Heads:	4

Other

Warranty:	5 Years
Hull Shape:	Catamaran
Builder:	Wider Yachts (Italy)

Full Specs

PAJOT CUSTOM ECO YACHT 90 CATAMARAN – New Construction E-Yacht Built by Wider – Delivery 18 Months from Order – New Concept Maxi Sailing Catamaran.

MAIN CHARACTERISTICS

- Builder: Wider Yachts (Italy)
- Model: Pajot Custom Eco Yacht 90'
- General conception: Wider – Pajot Custom Yachts
- Naval architecture : Nicolas Fauroux - Groupe Fauroux
- Structure engineering: Franck de Rivoyre - Christophe Larose
- Type: Maxi Catamaran / Sailing Catamaran
- Hull construction: Aluminium Silicium / 5083 / 5383
- Superstructure construction: Composite infusion
- Decks: Teak
- Length overall: 27.50 m (90')
- Hull water line length: 26.60 m (87' 3")
- Max beam: 12.00 m (39' 4")
- Hull beam: 2.90 m (9' 6")
- Bow freeboard: 2.66 m (8' 9")
- Stern freeboard: 2.78 m (9' 1")
- Height under loaded platform: 1.55 m (5' 1")
- Loaded draft (center board): 1.90 m (6' 3") / 3.70 m (12' 1")
- Loaded air draft (excluding antennas): 37.00 m (121' 5")
- Air draft without mast: 5.30 m (17' 5")
- Displacement: 67,000 kgs (147,710 lbs)
- Classification: RINA

SAILS

- Mainsail: 160 m² (1,722 sq. ft.)
- Genoa 1: 194 m² (2,088 sq. ft.)
- Genoa 2: 75 m² (807 sq. ft.)
- Staysail: 36 m² (387.5 sq. ft.)
- Gennaker: 380 m² (4,090 sq. ft.)
- Asymmetric spi: 600 m² (6,458 sq. ft.)

PROPULSION

- Type: Hybrid-electric motorisation
- Electric engines: 2 x 150 kW
- Cruising speed: 11 knots
- Max speed (engine): 13 knots

TANKAGE

- Fuel tanks capacity: 3,000 l (792.5 USG)
- Fresh water tanks capacity: 2,000 l (528.3 USG)

ACCOMMODATION

- Guest cabins: 3/4 Staterooms
- Max number of passengers: 10/12
- Crew cabins: 2/3
- Max crew: 3 - 4

OTHER MAIN EQUIPMENT

- Hydrogenerator (optional): 7 kW/h @ 12 knots
- Generators: 2 x 45 kW
- Solar panels: 47 m² 8 kW/h
- Watermakers: 2 x 120 l/h
- Water treatment plant: HEADHUNTER Marine sewage

TENDER

- Tender 5.80m (19') max (option)

Yacht Brochure

Available on request.

Warranty

5 years on the hull, 2 years on the rest of the ship's systems.

Delivery

18 Months from firm order.

Berth

Berth place management possible on French or Italian Riviera as well as Spain (Mainland and Balearic Islands), Greece and Turkey.

Spécifications Détaillées (Français)

PAJOT CUSTOM YACHTS 90 CATAMARAN – E-Yacht de Nouvelle Construction – Livraison 18 Mois à Partir de la Commande – Maxi Catamaran à Voile de Nouveau Concept.

CARACTÉRISTIQUES PRINCIPALES

- Constructeur : Wider Yachts (Italie)
- Modèle : Pajot Custom Eco Yacht 90'
- Conception générale : Wider – Pajot Custom Yachts
- Architecture navale : Nicolas Fauroux - Groupe Fauroux
- Ingénierie structure : Franck de Rivoyre - Christophe Larose
- Type : Maxi Catamaran / Catamaran à Voile
- Construction de coque : Aluminium Silicium / 5083 / 5383
- Construction de la superstructure : Infusion composite
- Ponts: Teck
- Longueur hors tout : 27,50 m (90')
- Longueur de la ligne de flottaison de la coque : 26,60 m (87' 3")
- Largeur maximum: 12,00 m (39' 4")
- Largeur de chaque coque : 2,90 m (9' 6")
- Franc-bord avant : 2,66 m (8' 9")
- Franc-bord arrière : 2,78 m (9' 1")
- Hauteur sous plateforme chargée : 1,55 m (5' 1")
- Tirant d'eau chargé (dérive centrale) : 1,90 m (6' 3") / 3,70 m (12' 1")
- Tirant d'air en charge (hors antennes) : 37,00 m (121' 5")
- Tirant d'air sans mât : 5,30 m (17' 5")
- Déplacement : 67 000 kg (147 710 lb)
- Classification: RINA

VOILES

- Grand-voile : 160 m² (1 722 pieds carrés)
- Génois 1: 194 m² (2 088 pieds carrés)
- Génois 2: 75 m² (807 pieds carrés)
- Trinquette : 36 m² (387,5 pieds carrés)
- Gennaker: 380 m² (4 090 pieds carrés)
- Spi asymétrique : 600 m² (6 458 pi²)

PROPULSION

- Type: Motorisation hybride-électrique
- Moteurs électriques : 2 x 150 kW (268 Cv)
- Vitesse de croisière: 11 nœuds
- Vitesse max (moteur): 13 nœuds

CAPACITÉS

- Capacité des réservoirs de carburant : 3 000 l (792,5 USG)
- Capacité des réservoirs d'eau douce : 2 000 l (528,3 USG)

AMÉNAGEMENTS

- Cabines invitées : 3/4 cabines chacune avec salle de bains privative
- Nombre maximum de passagers: 10/12
- Cabines équipage: 2
- Équipage maximum: 2 - 4

AUTRES ÉQUIPEMENTS PRINCIPAUX

- Hydrogénérateur (en option) : 7 kW/h à 12 nœuds
- Générateurs : 2 x 45 kW
- Panneaux solaires : 47 m² 8 kW/h
- Dessalinisateurs : 2 x 120 l/h
- Station d'épuration : HEADHUNTER Marine eaux usées

ANNEXE

- Annexe de 5.80m (19') max (option)

LIVRAISON

18 Mois à compter de la commande ferme.

GARANTIE

5 ans sur la coque, 2 ans sur le reste des systèmes du navire.

PLACE DE PORT

Gestion d'anneau d'amarrage possible sur la Côte d'Azur ou Riviera italienne ainsi qu'en Espagne (Continental et Baléares), en Grèce et en Turquie.

Disclaimer

These particulars are given in good faith as supplied to us but cannot be guaranteed and cannot be used for contracts



